



ABC50-H ABC80-H
 ABC65-H ABC95-H

Bottle Coolers

Features:

- Stainless steel exterior
- Stainless steel interior
- Electronic thermostat with digital LED display
- Temperature range 32F to 50F
- Doors with locks and keys
- Automatic defrost system
- High density CFC-free polyurethane foam
- Forced air refrigeration system maintains temperature
- Comes standard with 4" casters, 2 with brake
- Equipped with built in bottle cap opener and catcher
- Keeps organized with divider shelves



ABC50, ABC65, ABC80, ABC95 | Bottle Coolers

ABC50-H	
Doors	2
Dividers	3
Amps	2.3
HP	1/6
Voltage	115/60/1
Interior Size	44-3/4" x 18-7/8" x 27-3/8"
Size	49-3/8" x 27-3/4" x 38-1/2"
Shipping Weight	236

ABC65-H	
Doors	2
Dividers	4
Amps	2.3
HP	1/6
Voltage	115/60/1
Interior Size	60-3/4" x 18-7/8" x 28-3/8"
Size	64-3/4" x 27-3/4" x 38-1/2"
Shipping Weight	278

ABC80-H	
Doors	3
Dividers	5
Amps	2.8
HP	1/6
Voltage	115/60/1
Interior Size	75-3/4" x 19-3/8" x 27-7/8"
Size	80-1/2" x 27-3/4" x 38-1/2"
Shipping Weight	344

ABC95-H	
Doors	3
Dividers	6
Amps	2.3
HP	1/6
Voltage	115/60/1
Interior Size	90-1/2" x 18-7/8" x 28-3/8"
Size	95-3/8" x 27-3/4" x 38-1/2"
Shipping Weight	392

In the pursuit of a better product, durability and performance, Aurora reserves the right to change specifications, materials and design without further notice.

Bottle Coolers | ABC50, ABC65, ABC80, ABC95

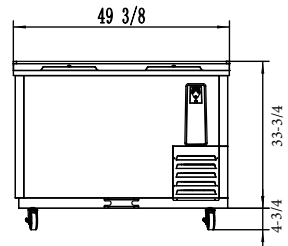
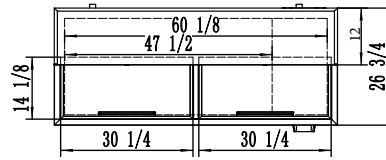
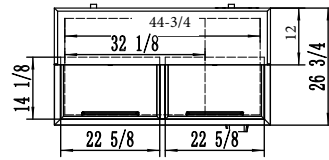

ABC50-H

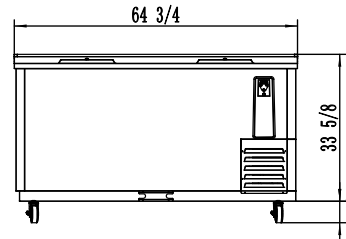

ABC65-H

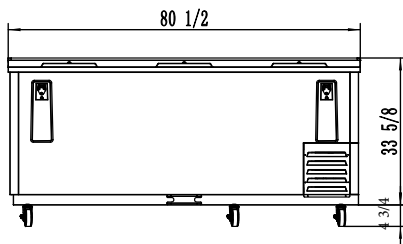
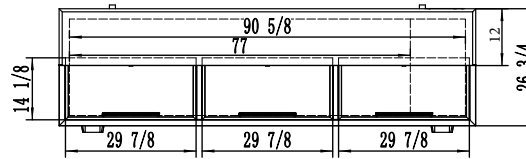
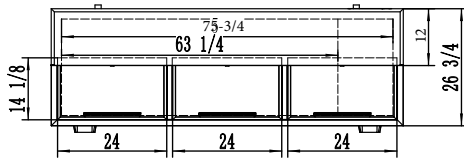

ABC80-H

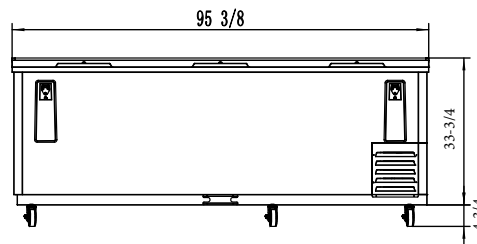

ABC95-H

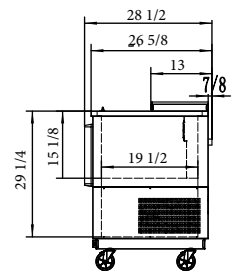

Side View

